

QCPF-MB-B38-01

SMP Connector, DC~18GHz

Features:
* Low VSWR

Applications:
* Wireless
* Radar
* Instruments
* Electronics

Electrical

Frequency:	DC~18GHz
Impedance of Dielectric:	5000MΩ min.
Voltage Withstand:	500V DC
Impedance:	50Ω

Mechanical

RF Connector:	SMP Male
Mating Life Cycle:	100 cycles
Detent mode:	Full detent
Outer Conductor:	Gold Plated Brass
Dielectric:	PEEK
Inner Conductor:	Gold Plated Beryllium Copper

Environmental

Temperature:	-55~+165°C
--------------	------------

Outline Drawings

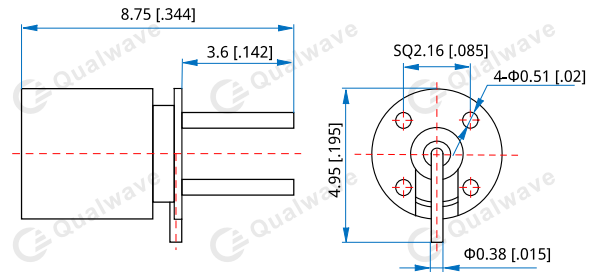

Unit: mm [in]
Tolerance: ±0.2mm [±0.008in]

How To Order

QCPF-MB-B38-01

Customization is available upon request.