

## QBF-2025-2120-50

### High Stopband Rejection

**Features:**

- \* High Stopband Rejection
- \* Small Size

**Applications:**

- \* Telecom
- \* Laboratory Test
- \* Receivers
- \* Instrumentation

#### Electrical

Passband:	2.025~2.12GHz
Passband Ripple:	1dB max.
Insertion Loss at CF:	2dB max.
VSWR:	1.3dB max.
Stopband Attenuation:	50dB@1.95GHz min. 50dB@2.2~2.3GHz min.

#### Mechanical

Size <sup>*1</sup> :	75*52*21mm 2.953*2.047*0.827in
RF Connectors:	SMA Female
Mounting:	4* $\Phi$ 2.8 Through-hole

[1] Exclude connectors.

#### Environmental

Working Temperature:	-40~+75°C
Storage Temperature:	-55~+85°C

#### Outline Drawings

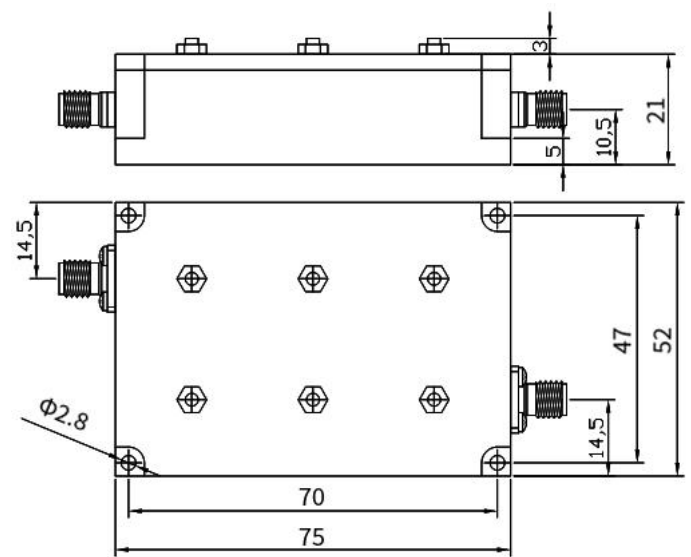

Unit: mm

Tolerance:  $\pm 0.2$ mm

#### How To Order

**QBF-2025-2120-50**

Customization is available upon request.