

QCS-MG-A360-1

SMA Male

Features:
* Low VSWR

Applications:
* Wireless
* Radar
* Instruments
* Electronics

Electrical

Frequency: DC~26.5GHz
VSWR: 1.25 max.
Impedance: 50Ω

Mechanical

RF Connector: SMA Male
Mating Cable: QA360
Outer Conductor: Passivated Stainless Steel
Inner Conductor: Gold Plated Brass

How To Order

[QCS-MG-A360-1](#)

Customization is available upon request.

Outline Drawings

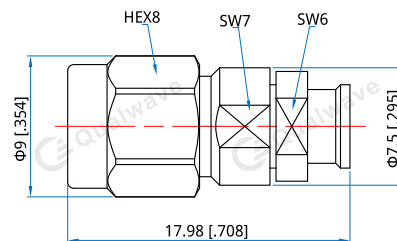

Unit: mm [in]

Tolerance: ± 0.2 mm [± 0.008 in]

Stripping Reference

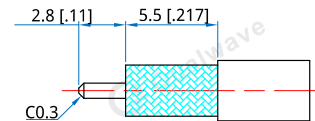

Unit: mm [in]

Tolerance: ± 0.1 mm [± 0.004 in]