

QDI3030B

High Power, High Isolation

Features:
 * High Power
 * High Isolation
 * Low Insertion Loss
 * Low VSWR

Applications:
 * Wireless
 * Radar
 * Laboratory Test

Description

QDI3030B series Drop-In Isolators cover frequency range 2~6GHz. High power, high isolation and low insertion loss make it ideal for a lot of applications like amplifiers, transceivers, etc.

Specifications

Frequency (MHz)	Bandwidth (MHz)	Insertion Loss (dB Max.)	Isolation (dB Min.)	VSWR (Max.)	Average Power (W)	Temperature (°C)
2000~6000	4000	1.7	12	1.6	20	-40~+70

Outline Drawings

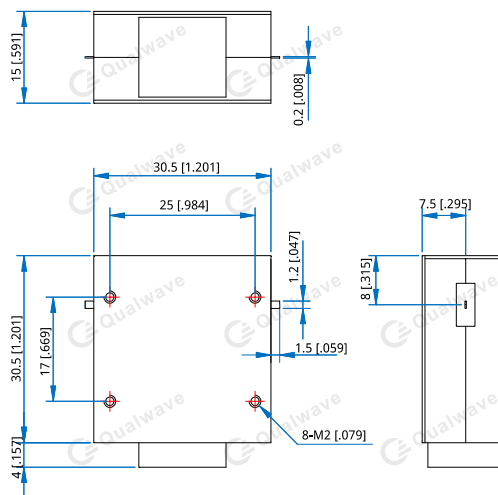

Unit: mm [inch] Tolerance: ±0.2mm [±0.008in]

Mechanical

Size*1: 30.5*30.5*15mm
 1.201*1.201*0.591in
 Connector Type: Strip line
 Mounting: 8-M2mm deep 4 mm

[1] Exclude connectors

Direction Naming Rules:

- 1 - Clockwise
- 2 - Anticlockwise

Customization is available upon request.

How To Order

QDI3030B-V-W-X-Y-Z

V: Start frequency in MHz
 W: Stop frequency in MHz
 X: Forward Power in W
 Y: Reverse Power in W
 Z: Direction type

Examples:

To order a QDI3030B series Isolator, 2~6GHz , Forward power 20W, Reverse power 20W, Clockwise, specify QDI3030B-2000-6000-20-20-1.